

LS - W

TUNGSTEN-HALOGEN LIGHT SOURCE

- *Visible-NIR Spectral Range*
- *Adjustable Power Output*
- *Optical Fiber Connector*
- *Built-in Filter Slot*
- *Remote Control with SPEC Hub*



POWERFUL AND FLEXIBLE

With W light source you have the possibility of choosing from four different tungsten-halogen lamps (7, 14, 20, and 25 watts) that range from 300-3000 nm for the 20 watts lamp and 380-3000 nm for the 7, 14, and 25 watts lamps. The included slide filter holder allows great flexibility, including narrowing the spectral range (by using band-pass, short-pass or long-pass filters)

SHUTTER FOR MAXIMUM PERFORMANCE

The built-in shutter controller included on the W light source provides a simple operation for dark measurements without the need for shutting off the lamps, resulting in a more stable and extended lifetime.

ADJUST THE LIGHT INTENSITY

LS-W has an adjustable power output knob to locally control the amount of light that reaches your sample.



Reflectance (Vis Range) Setup Example

- ① LS-W Light Source
- ② Reflectance Probe
- ③ Probe Holder
- ④ FLEX Spectrometer

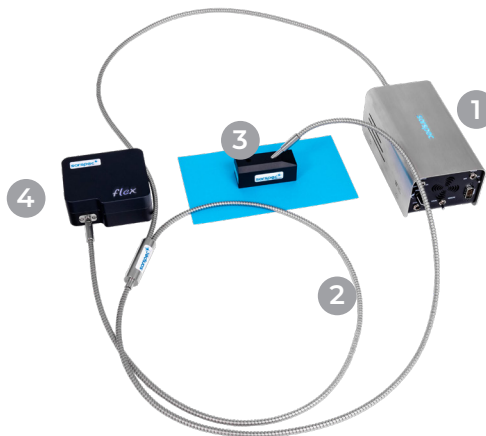

Specifications Table

	LS-W7	LS-W14	LS-W20	LS-W25
Wavelength range	380 - 2500 nm	380 - 2500 nm	300 - 2500 nm	380 - 2500 nm
Tungsten-Halogen lamp power	7 W	14 W	20 W	25 W
Tungsten-Halogen lamp lifetime	~ 4000 h	~ 4000 h	~ 1500 h	~ 4000 h
Optical Filter Slot	Filter Slot and Slide Filter Holder included (holds 1 filter with 12.7 mm diameter and 3 mm maximum thickness)			
Local operation	Shutter controller, intensity control knob, Remote / Local selector			
Optical fiber connector	SMA 905 with adjustable focus			
Time for a stable output	Approx. 15 min.			
Remote operation	Shutter, Lamp enabling (TTL compatible signals) and Intensity control (analog and PWM) - best with optional SPEC Hub			
Lamp cooler system	Air cooling			
Power consumption (maximum)	12 W	19 W	25 W	30 W
Power requirements	24 VDC/ 2 ADC			
Dimensions / Weight	200 (L) x 92 (W) x 72 (H) mm / 1.1 kg			

Order Information

Light Source	LS-W7	LS-W14	LS-W20	LS-W25
Replacement Lamp	B-W7	B-W14	B-W20	B-W25
SPEC Hub (cable included)	HUB-LS			



+351 223 709 107



www.sarspec.com



info@sarspec.com

